

Application for a Resource Consent – Resource Management Act 1991

This application form must be provided with applications to the council for new and replacement resource consents, and changes to the conditions on an existing resource consent.

If you would like to talk or meet with a consents officer to discuss your application prior to lodging with the council, please phone **0800 002 004** or email request to info@nrc.govt.nz.

PART 1: Administration Matters

1 Full Name of Applicant(s) *(the name(s) that will be on the resource consent document)*

Surname: KRAUSE

First Names: ERWIN

OR

If the application is being made on behalf of a trust, the Trustee(s) who has/have signing authority for the trust must be named.

Trust Name: _____

Trustee's Name(s): _____

OR

Company Name: _____

Contact Person: _____

Email address: e.krause@extra.co.nz or info@mode-krause.de

Please Note: If an email address is provided, then all correspondence for this application will be via email.

Postal address: P.O. Box 346 Mangonui

Telephone: *(please tick preferred contact number)*

Residential 09-4061780

Business ~~0049-171-3171049~~

Mobile 0274-978662

0049-171-3171042
- Germany -

2 Details of the Address for Service of documents if different from the Applicant (e.g. Consultant). This address will be used for all documents if completed.

Company Name:

Contact Person:

Email address:

Please Note: If an email address is provided, then all correspondence for this application will be via email.

Postal address:

Telephone: (please tick preferred contact number)

Residential Business

Mobile

3 Invoices

Charges relating to the processing of this resource consent application should be sent to:

Applicant Address for service

Charges relating to the ongoing monitoring of a resource consent should be sent to:

Applicant Address for service

4 Name and Address of all Owners/Occupiers of the Site relating to Application if different from the Applicant

Owner(s):

Postal Address:

Telephone: (please tick preferred contact number)

Residential Business

Mobile

Occupier(s):

Postal Address:

Telephone: (please tick preferred contact number)

Residential Business

Mobile

Please Note: If the applicant is not the owner of the land to which the activity relates, then it is good practice to submit the application with written approval from the landowner.

5 Extending Timeframes

The Resource Management Act 1991 (RMA) specifies timeframes for processing resource consent applications (e.g. 20 working days for a non-notified application); however, these timeframes can be extended, if necessary, with the Applicant's agreement. If the council does not meet these timeframes, then it is required to refund 1% of the total processing cost of the application for each day it exceeds the timeframe up to a maximum of 50%.

Do you agree to the council extending RMA resource consent processing timeframes?

- Yes**, provided that I can continue to exercise my existing resource consent until processing of this application is completed.
(Replacement application only. No refund is required to be paid until after the existing resource consent expires.)
- Yes**, provided that the extension is for the specific purpose of discussing and trying to agree on resource consent conditions.
- Yes**, provided that the application process is completed before this date (dd/mm/yy):
- No**.

6 Deposit Fee

An initial minimum fee is payable with this application. These fees can be found on the council's website www.nrc.govt.nz – [Schedule of Minimum Estimated Initial Fees](#) information. Please contact council consents staff if you need assistance with determining the correct minimum initial fee.

Unless agreed to prior to lodging your application, the council will not commence processing your resource consent application until payment of the minimum initial fee is received (i.e. the statutory processing time for the application will not start).

This minimum initial fee may be paid online, or by EFTPOS at one of the council's offices.

Instructions for paying online can be found on the council's website at "[Pay online](#)". Please use either the first six numbers of your resource consent (e.g. CONXXXXXX or AUT.XXXXXX), if known, or the Applicant's name as the Reference/Customer number when paying online.

If you do pay online, then please enclose evidence of payment so that the council is aware that the payment has been made.

If the costs of processing the resource consent application are greater than the minimum estimated initial fee, then the applicant will be required to pay the additional actual and reasonable costs of processing the application.

Note: Annual User Charges for Resource Consent Holders

Holders of resource consents will in most cases be required to pay a "Minimum Annual Charge" for administration of the resource consent once issued. There is also likely to be additional annual charges for the monitoring of the resource consent, which will be dependent on the type of activity the resource consent is for. These charges are detailed on the council's website www.nrc.govt.nz in the Annual Charges section of the council's [Charging Policy](#).

Fees of NZD 852.50 have been transferred:
Reference#: PAY22111471

PART 2: Application Details

1 Description of Activity

Please describe in detail the activity for which resource consent is being sought.

Replacement of existing CON 19990871001

2 Location Description of Activity

Site Address: 247, WAIKUA-ROAD; HIHI-MANGONUI

Legal Description: GOLDMINE-BAY

(Legal description can be obtained from your Certificate of Title, valuation notice, or rates demand)

3 Site Plan

On a separate page (*minimum A4 size*), please provide a site plan showing the location of the activity, site layout, and surrounding environment in relation to property boundaries. Please include any buildings or developments on the site.

These plans should be provided electronically and be of good quality, to enable use in resource consent documentation.

If you do not have access to mapping software, we recommend you use the council's "[Property and Boundaries](https://localmaps.nrc.govt.nz/LocalMapsGallery/)" map available on our website <https://localmaps.nrc.govt.nz/LocalMapsGallery/>.

This council map contains aerial photography and shows property boundaries and details. You can carry out a property search and print maps of aerial photography.

4 Resource Consent(s) being Applied for

Coastal Permit

Mooring

Marine Farm

Structure

Pipeline/Cable

Other (*specify*)

Land Use Consent

Quarry

Earthworks

Dam Structure

Vegetation Clearance

Construct/Alter a Bore

Structure in/over Watercourse

Other (*specify*)

Water Permit

- Stream/Surface Take Damming Groundwater Take
 Diverting Water Other (specify)

Discharge Permit

- Domestic Effluent to Land General Discharge to Land Farm Dairy Effluent to Land/Water
 Air Water Other (specify)

5 Is this application to replace an existing or expired resource consent(s)? Yes No

If Yes:

(a) Please state the resource consent number(s):

CON 1999 08710 01

(b) Do you agree to surrender the existing resource consent once a new one has been issued:

Yes No

6 Is this application to change a condition of an existing resource consent? Yes No

If Yes, please state the resource consent number(s):

.....
.....

7 Please specify the duration sought for your resource consent(s) –

Only for new or replacement applications.

35 years months

8 Do you also require consent(s) from a district council? Yes No

If Yes, please complete the following:

Type of consent required?

Has it been applied for? Yes No

Has it been granted? (If Yes, please attach) Yes No

Information Privacy Issues

The information you provide in this application is regarded as official information. It is required under the provisions of the Resource Management Act 1991 to process this application. The information will be held by the council and is subject to the provisions of the Local Government Official Information and Meetings Act 1987, and the Privacy Act 1993. The information you provide in this application will generally be available to the public.

Under Section 88 and/or 127 of the Resource Management Act 1991 (RMA), the undersigned makes this application for resource consent(s).

- 1 I/We confirm that I have authority to sign on behalf of the person(s) named as the applicant(s) for this application for resource consent.
- 2 I/We have read, and understand, all of the information contained within this application form, including the requirement to pay any additional actual and reasonable costs for the processing of the application.
- 3 I/We confirm that all of the information provided is true and correct and I understand that any inaccurate information provided could result in my resource consent (if granted) being cancelled.

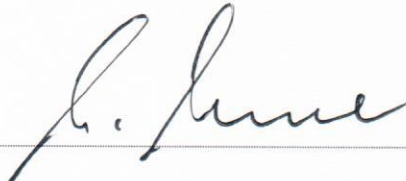
Signature(s): 

Date: 6.11.2022

Signature(s): _____

Date: _____

Signature(s): _____

Date: _____

Please note that a signature is not required if submitting application electronically.

Part B Assessment of Environmental Effects – Minor Coastal Activity



| | | |
|-------------------|--------|------------------|
| Whangārei Office | Phone: | 09 470 1200 |
| Kaitiāia Office | Phone: | 09 408 6600 |
| Waipapa Office | Phone: | 09 470 1200 |
| Dargaville Office | Phone: | 09 439 3300 |
| Free Phone | | 0800 002 004 |
| Email | | info@nrc.govt.nz |
| Website | | www.nrc.govt.nz |

This application is made under Section 88/Section 127 of the Resource Management Act 1991

To: Consents Department
Northland Regional Council
Private Bag 9021
Te Mai
Whangārei 0143

PART B – ASSESSMENT OF ENVIRONMENTAL EFFECTS

Your application must include an Assessment of Effects on the Environment. This form and the associated Information Requirement Booklet will help you prepare it.

An assessment of effects is required so that you and others can understand what happens to the environment when you carry out a minor coastal activity, whether it is existing or new. This will help you to propose ways to minimise those effects to the council's satisfaction.

The degree of detail required is in proportion to the scale of the environmental effects of your proposal. If the size of your proposed activity or the scale of its potential effects is significant, a report by a professional advisor in support of your application may be required.

Please note that the word "environment" includes the surrounding coastal water, adjoining land, any surrounding resource users, and local iwi.

It is advised that you make an appointment with a council officer to discuss your application prior to lodging it. This will help you supply all the required information at the onset and ensure the efficient processing of your application.

A. Describe the Proposed Activity

A.1 Describe the proposed activity(ies):

Existing boat ramp 15 x 4.5 m
as shown on existing map.

Minor Coastal Activity – AEE 10

A.2 Is the proposed activity new, or an alteration/extension of an existing activity or structure? New Existing

A.3 If the application is to continue or alter an activity or structure, is there any previous resource consent or authority (e.g. Harbours Act approval or Water Right)? No Yes

If so, what are the existing permit numbers?

CON19990871001

ATTACH A COPY OF THE APPROVAL

B. Site Details

B.1 Describe the site of the proposed activity, including reference to existing structures in the coastal marine area and on the adjacent land. Ensure that a detailed map is provided as outlined on page 3.

See existing details at FNRC as consented.

B.2 Describe the seabed materials (e.g. rock, sand, or shingle) at the site of the activity and in the surrounding area.

Sand and pebbles

B.3 Describe the plants and animals (e.g. mangroves, saltmarsh or shellfish beds) at the site of the activity and the surrounding area.

Nothing special

B.4 Describe any cultural areas, historic areas, scenic features and food gathering areas within 500 metres of the proposed activity.

Nothing known

B.5 You **must** attach a map that shows the following (refer to page 3):

- the location of the proposed activity,
- the legal boundaries of any adjoining properties,
- any adjacent public roads, esplanade reserves, marginal strips,
- the location of the coastal marine boundary (i.e. mean high water springs),
- the location of any existing coastal activities within 500 metres (including existing structures.)

It is also advised that you supply photographs of the site and the surrounding area.

Nothing changed from original consent.

B.6 If the application includes any structure (e.g. jetty, boat ramp, or discharge pipes), you **must** attach a structure plan that shows the following (refer to page 4):

- the dimensions of the structure,
- front view
- side view
- plan view
- position of mean high water springs (MHWS) – i.e. high tide mark.

Please see existing consent-file

C. Assessment of Effects on the Environment

C.1 Will the proposed activity have any impact on plant, animal or marine life?

No, why not?

Exists since 2005 without any problems

Yes, describe impact

C.2 Describe the visual impact the proposal will have, and include an assessment of compatibility with existing activities, structures and surroundings.

All unchanged since 2005 – no visual impacts

C.3 Will the proposed activity have any impact on other users of the area?

(include any restriction on public access to and along the foreshore, during construction and/or once construction is finished)

No, why not?

There were never ever any complaints in the past.
Nothing expected in the future.

Yes, describe impact

Minor Coastal Activity – AEE 10

C.4 Will the proposed activity have an effect on coastal processes of the area (e.g. erosion) and/or on water quality?

No, why not?

Existing structure will either be altered
nor expanded

Yes, describe impact

C.5 Mitigation Measures

If you have identified any potential effects that may be more than minor in your assessment above, please consider and describe the steps you propose to take to mitigate these effects.

No potential effects expected

C.6 Alternatives

Sometimes the adverse effects of a proposal can be mitigated by the consideration of alternatives. Please identify and describe any alternative locations/designs/methods.

C.7 Consultation

Written approvals regarding your proposal are normally required from the adjoining land owners/occupiers and consultation undertaken with the Department of Conservation and local Iwi is advised. If there is an adjacent esplanade reserve (marginal strip) administered by the Department of Conservation or the district council, then written approval is normally required from that agency.

Any letters of concern/support or comment from persons consulted should be attached to this application form.

The Northland Regional Council can supply you with prescribed written approval forms to aid you with the consultation.

Will the proposed activity have an effect on any neighbouring property owners?

No, why not?

*No objections nor complaints in the past.
No changes in the future expected.*

Yes, describe impact

Have you consulted with any of the following potentially affected parties?

| | Yes | No |
|--|--------------------------|-------------------------------------|
| Neighbours | <input type="checkbox"/> | <input checked="" type="checkbox"/> |
| Other users of the coastal marine area | <input type="checkbox"/> | <input checked="" type="checkbox"/> |
| Department of Conservation | <input type="checkbox"/> | <input checked="" type="checkbox"/> |
| District Council | <input type="checkbox"/> | <input checked="" type="checkbox"/> |
| Local iwi (specify): _____ | <input type="checkbox"/> | <input checked="" type="checkbox"/> |
| Other (specify): _____ | <input type="checkbox"/> | <input checked="" type="checkbox"/> |

Please attach a record of any consultation which has taken place. The council has forms to aid with this consultation.

Please ensure all the relevant questions on this form have been answered fully.

If you have any queries relating to information requirements or wish to meet with a council consents officer, please contact the Northland Regional Council.

Northland Regional Council offices:

| | | | |
|--|---|--|--|
| Whangārei Office 36 Water Street Whangārei 0110 Phone: 0800 002 004 Email: info@nrc.govt.nz | Dargaville Office Ground Floor 32 Hokianga Road Dargaville 0310 Phone: 09 439 3300 | Kaitiāia Office 192 Commerce Street Kaitiāia 0410 Phone: 09 408 6600 | Waipapa Office Shop 9 12 Klinac Lane Waipapa 0295 Phone: 0800 002 004 |
|--|---|--|--|



Resource Consent

Pursuant to the Resource Management Act 1991, the Northland Regional Council (hereinafter called "the Council") does hereby grant a Resource Consent to:

Erwin KRAUSE, P O BOX 346, MANGONUI 0557

To place, use, and occupy space with, a boat ramp in the coastal marine area, at location coordinates 1648210E 6132230N in Goldmine Bay, Doubtless Bay.

Note: All location co-ordinates in this document refer to Geodetic Datum 2000, New Zealand Transverse Mercator Projection.

Subject to the following conditions:

- 1 This consent applies only to the area identified on NRC Plan No. 3505 **attached**.
- 2 The Consent Holder shall mark the structure with the number **8710** in black lettering on a white background clearly displayed and in such a manner as to be clearly visible from land/sea.
- 3 The Consent Holder shall keep the coastal marine area free of debris resulting from the Consent Holder's activities.
- 4 The Consent Holder shall maintain the structure covered by this consent in good order and repair.
- 5 The Consent Holder shall, for the purposes of adequately monitoring the consent as required under Section 35 of the Act, on becoming aware of any contaminant associated with the Consent Holder's operations escaping otherwise than in conformity with this consent:
 - (a) Immediately take such action, or execute such work as may be necessary, to stop and/or contain such escape; and
 - (b) Immediately notify the Council by telephone of an escape of contaminant; and
 - (c) Take all reasonable steps to remedy or mitigate any adverse effects on the environment resulting from the escape; and

- (d) Report to the Council in writing within one week on the cause of the escape of the contaminant and the steps taken or being taken to effectively control or prevent such escape.
- 6 The Northland Regional Council may, in accordance with Section 128 of the Resource Management Act 1991, serve notice on the Consent Holder of its intention to review the conditions of this consent. Such notice may be served annually during the month of June. The review may be initiated for any one or more of the following purposes:
- (a) To deal with any adverse effects on the environment that may arise from the exercise of the consent and which it is appropriate to deal with at a later stage, or to deal with any such effects following assessment of the results of the monitoring of the consent and/or as a result of the Regional Council's monitoring of the state of the environment in the area.
 - (b) To require the adoption of the best practicable option to remove or reduce any adverse effect on the environment.
 - (c) To provide for compliance with rules in any regional plan that has been made operative since the commencement of the consent.
 - (d) To deal with any inadequacies or inconsistencies the Council considers there to be in the conditions of the consent, following the establishment of the activity the subject of the consent.
 - (e) To deal with any material inaccuracies that may in future be found in the information made available with the application. (Notice may be served at any time for this reason.)
 - (f) To change existing, or impose new limits on conditions.

The Consent Holder shall meet all reasonable costs of any such review.

- 7 Prior to the expiry, cancellation, or lapsing of this consent the Consent Holder shall remove all structures and other materials and refuse associated with this consent from the consent area and shall restore the consent area to the satisfaction of the Northland Regional Council, unless an application for a replacement consent has been properly made beforehand.

EXPIRY DATE: 30 JUNE 2023

ISSUED at Whangarei this Sixth Day of April 2005

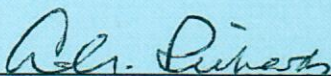

Allan Richards
Coastal Consents Team Leader

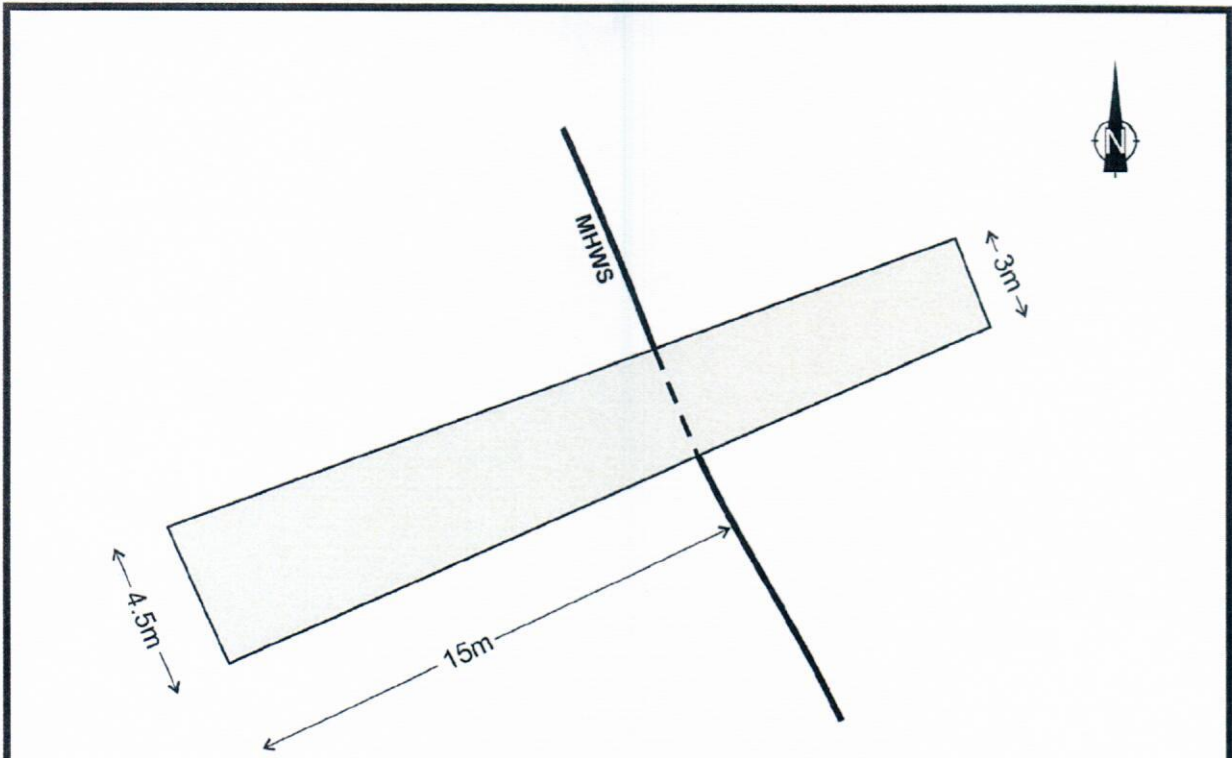

CONSENT LOCATION

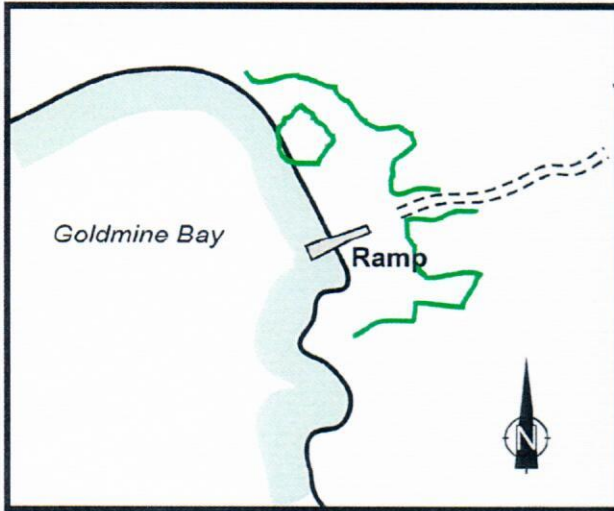

Location Co-ordinates:
 Datum: NZTM
 Easting: 1648210
 Northing: 6132230



RESOURCE CONSENT
CON19990871001
 For
E Krause
Boat Ramp - Goldmine Bay - Doubtless Bay

Scale: N.T.S.
 Drawn: CNA 02/05
 App'd: *[Signature]* 03/05
 Plan No.
3505